

Tous droits strictement réservés. Reproduction ou communication o des liens interdite sous quelque forme que ce soit sans autorisation écrite du propriétaire. Propriete de c FCI. Droits de reproduction FCI.

**FCI**

All rights strictly reserved. Reproduction or issue to third parties in any form whenever is not permitted without written authority from the proprietor. Property of FCI. Copyright FCI.

PRODUCT No.	ROWS	POWER						SIGNAL								POWER			E2	
		E1	P1	P2	P3	P4	P5	P6	1	2	3	4	5	6	7	8	P7	P8		P9
51935-001	D C B A		PA	PA	PA	PA	PA	PA	X	H	U	U	X	X	X	X	PA	PA	PA	
									X	T	T	T	X	X	X	X				
									X	S	S	S	X	X	X	X				
									X	R	R	R	X	X	X	X				

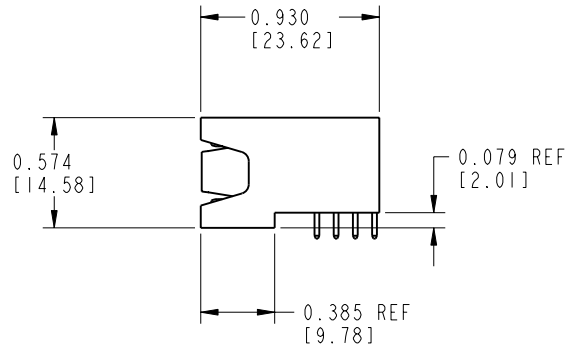
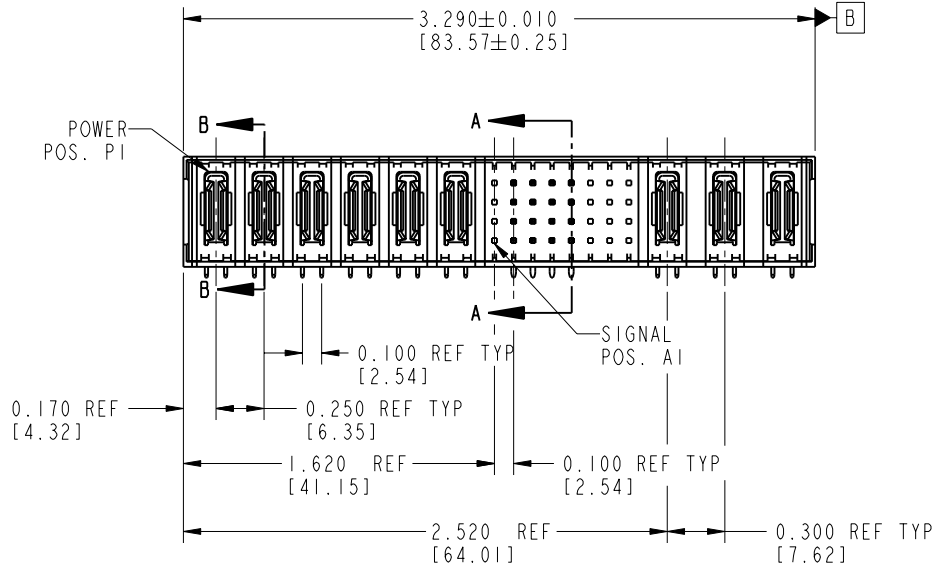

CODE	DIM "M" MATING LENGTH ±0.010	CONTACT TYPE
H	0.220 [5.59]	SIGNAL
R	0.270 [6.86]	SIGNAL
S	0.270 [6.86]	SIGNAL
T	0.270 [6.86]	SIGNAL
U	0.270 [6.86]	SIGNAL
PA	N/A [N/A]	POWER
X	OMITTED	OMITTED

mat'l code				tolerances unless otherwise specified		CUSTOMER COPY	FCI		www.fciconnect.com		
ltr	ecn no.	dr	date	linear	.XX±.01/0.X±0.3	projection	INCH/MM	scale	1:1	title	6P + 16S + 3P RIGHT ANGLE SOLDER HEADER
A	V12127	JRW	7/31/01	angles	.XXX±.005/0.XX±0.13						
B	V12156	JRW	8/14/01		.XXX±.0020/0.XXX±0.051					product family	PwrBlade
C	DG06-0005	JMG	01/06/06		0°±2°					code	213
				dr	J. WITMER	7/31/01				size	dwg no
				engr	J. ALLISON	7/31/01				A	51935-001
				chr	J. ALLISON	7/31/01				sheet	1 OF 2
				appd	J. ALLISON	7/31/01					
sheet index	revision sheet	C	C								
		1	2								

1 | 2

Pro/E

3 |

cage code 22526

4

PDM: Rev:C

STATUS: Released

Printed: Aug 15, 2007

Tous droits strictement réservés. Reproduction ou communication o des liens interdite sous quelque forme que ce soit sans autorisation écrite du propriétaire. Propriété de c FCI. Droits de reproduction FCI.

All rights strictly reserved. Reproduction or issue to third parties in any form, whatever is not permitted without written authority from the proprietor. Property of FCI. Copyright FCI.

PRODUCT NUMBER  
51935-001\_\_

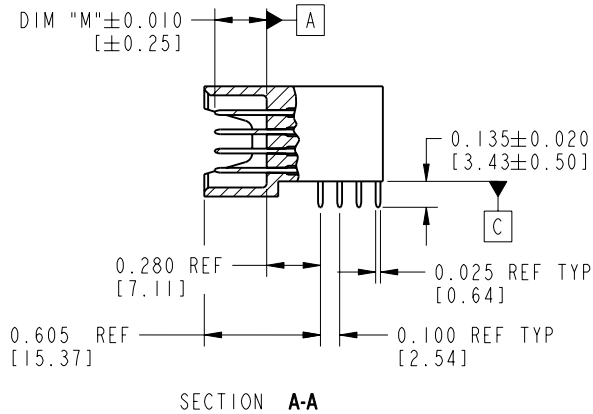

SECTION A-A

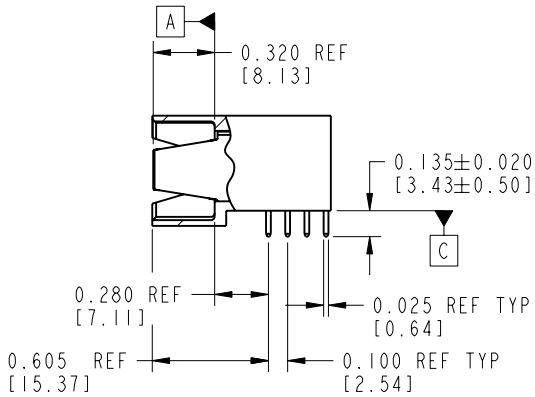

SECTION B-B

CONNECTOR NOTES:

- HOUSING MATERIAL: UL 94 V-0 GLASS FILLED HIGH TEMP THERMOPLASTIC  
POWER CONTACT MATERIAL: COPPER ALLOY  
SIGNAL CONTACT MATERIAL: COPPER ALLOY
- 51935-001; 51935-001LF; 51935-001GLF PLATING SPEC. SEE PRINT: 10064183  
"MANUFACTURER'S" NAME, P/N, AND DATE CODE TO APPEAR ON THIS SURFACE
- PRODUCT SPECIFICATION GS-12-149
- PCB NOTES:
  - ALL DIMENSIONS ARE BASIC UNLESS OTHERWISE SPECIFIED.
  - ALL THROUGH HOLES ARE LOCATED WITH A TRUE POSITION OF  $\varnothing 0.004$  [0.10]
  - ALL HOLE DIAMETERS ARE FINISHED HOLE SIZE
  - $\varnothing 0.0453 \pm 0.0010$  [1.151  $\pm$  0.025] DRILLED HOLES PLATED WITH 0.0003 [0.008] MIN SnPb OVER 0.001 [0.03] TO 0.003 [0.08] Cu PLATING TO ACHIEVE A  $\varnothing 0.040 \pm 0.003$  [1.02  $\pm$  0.07] HOLE.

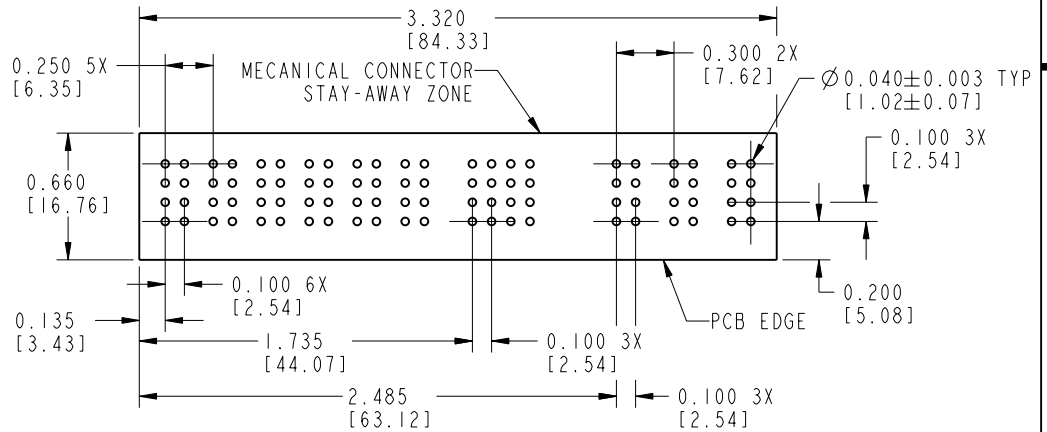

RECOMMENDED PCB LAYOUT

mat'l code				SEE NOTE 1		tolerances unless otherwise specified		CUSTOMER COPY		 www.fciconnect.com	
ltr	ecr no.	dr	date	linear	.XX ± .01 / 0.X ± 0.3	projection			title		
c				angles	.XXX ± .005 / 0.XX ± 0.13			6P + 16S + 3P RIGHT ANGLE SOLDER HEADER			
				dr	.XXX ± .0020 / 0.XXX ± 0.051	INCH/MM		product family		PwrBlade	code
				engr	J. WITMER 7/31/01	scale		size		dwg no	213
				chr	J. ALLISON 7/31/01	1:1		A		51935-001	sheet
				appd	J. ALLISON 7/31/01						2
sheet index		revision sheet									

cage code 22526

Pro/E

PDM: Rev:C

STATUS: Released

Printed: Aug 15, 2007